

Julio Le Parc painting

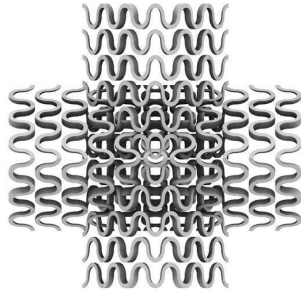

Iteration 01

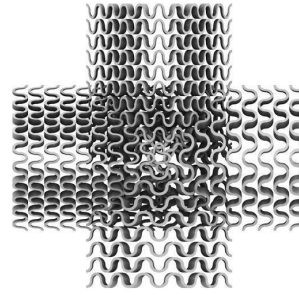

Iteration 02

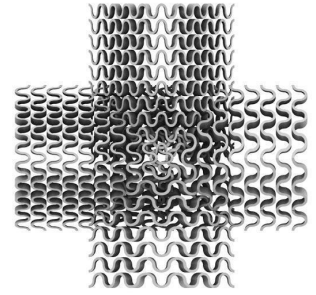

Iteration 03

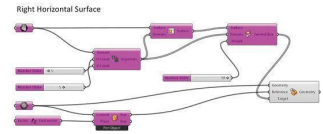
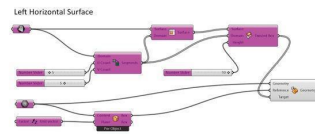
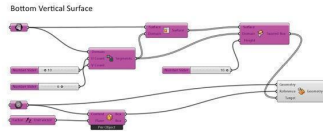
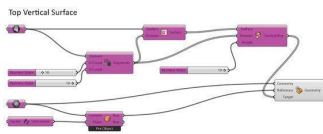

Grasshopper definition

*Lucia Romanato - Arch 436 Advanced Modeling - Spring 2020*

## REQUIREMENTS:

**Watch** the following tutorial:

[Grasshopper 3D Box Morph Tutorial](#)

**Model** your 'Community Space' project in Rhino

**Identify** an opportunity in your design for a parametric intervention (wall, roof, interior architectural element, landscape, etc.).

**Explore** your chosen element in at least (4) different states (iterations).

**Provide** your grasshopper scripts for each iteration. Note which parameters were adjusted to achieve each iteration.

**Produce** a perspective rendering for each iteration. Rendered views should showcase your parametric intervention. Renderings must be hybrid **line, shade, and shadow** drawings and include the following:

- Scale figures
- Grasshopper scripts

**Compose** your (4) renderings on (1) 11" x 17"

## DUE DATE AND TIME:

Before Class-13

**SUBMIT:** Upload a single PDF file with (1) page to your individual drive folder

## FILE NAMING:

FIRSTNAME\_LASTNAME\_A#.PDF

**\*\*See student work samples on next 2 pages\*\***

**NOTE: SAMPLES BELOW DO NOT MEET ALL OF THE ASSIGNMENTS REQUIRED CRITERIA**

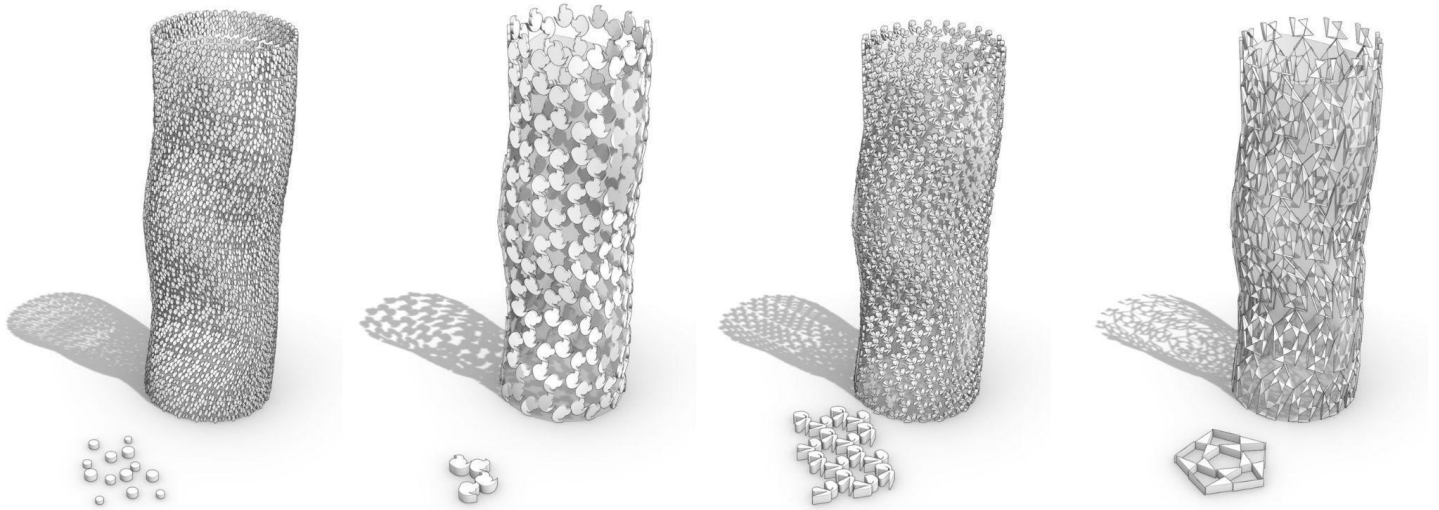

*\*Sample above is missing Grasshopper scripts & scale figures*

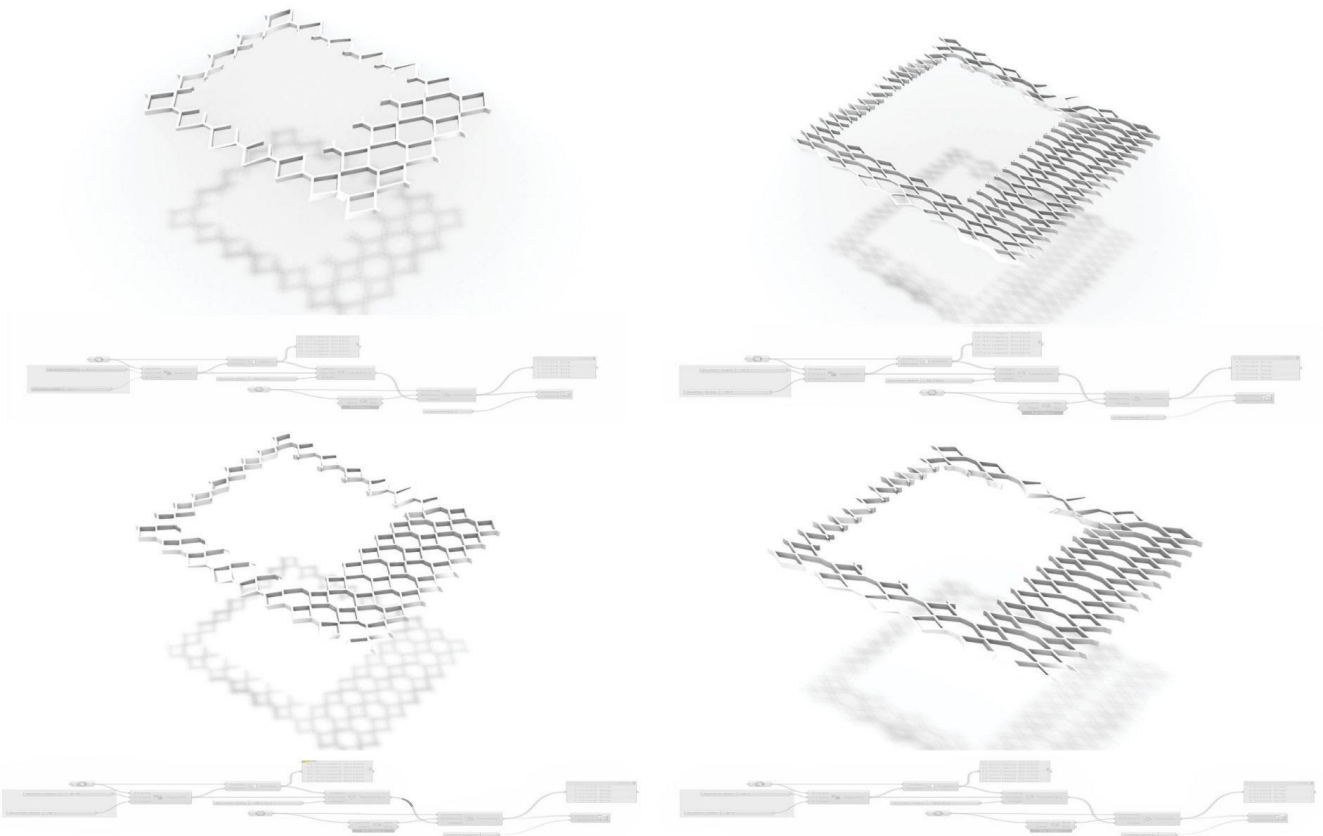

*\*Sample above is missing scale figures*



*\*Sample above is missing Grasshopper scripts*

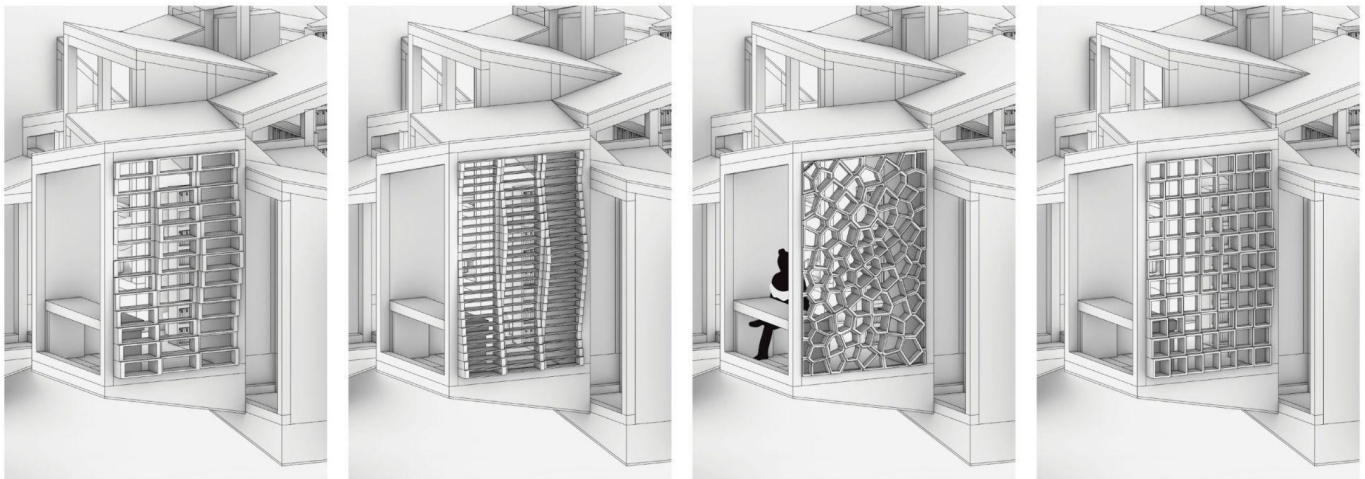

*\*Sample above is missing Grasshopper scripts*